

# Lameco MassiveLog®

## Laminated logs



### Even more massive log from Lameco!

**Lameco MassiveLog®** is even stronger than before.

From the beginning of year 2010, domestic regulations in Finland require the U-value of a timber wall to be max must reach  $0.40 \text{ W}/(\text{K}\cdot\text{m}^2)$ .

Lameco has responded to the tightening requirements by presenting a new 270 mm thick timber. The 270 mm timber glued from eight different pieces will give the timber building a truly aesthetic appearance.

Lameco offers the 270 mm timber as preforms, profiled timber and also as readymade frames.

### Request samples of our new timber.

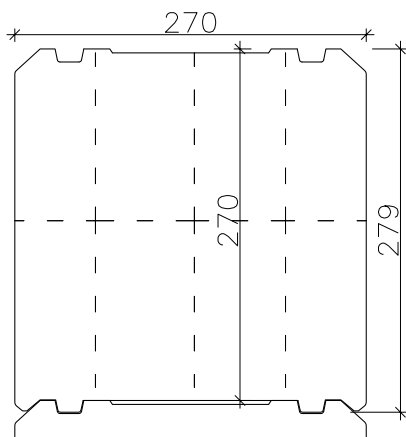

270 x 279 (270)  
280 x 279 (270)



**LAMECO**  
LAMINATED PRODUCTS

Lameco LHT Oy  
Hirsitie 1, 73200 Varpaisjärvi  
tel. +358 17 775 270  
fax +358 17 775 271  
[www.lamecolht.fi](http://www.lamecolht.fi)