

SYSTEM FEATURES AND BENEFITS

A sports floor system, consisting in general of a vapor barrier, resilient Rezill pads, wood subfloor, edge grain maple flooring, sanding, sealers, finishes, game lines and wall base.

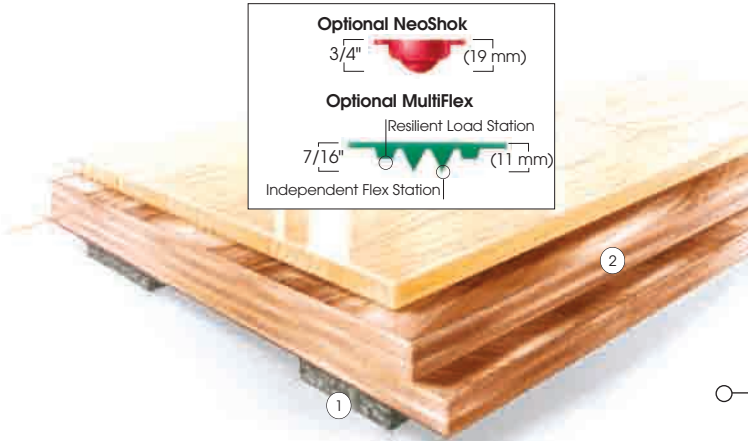
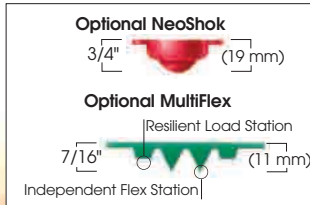

- ① Rezill Pad
- ② Two layers of 15/32" (12 mm) APA rated Plywood subfloor

SPECIFICATIONS

MANUFACTURING

ISO 9001:2000
CERTIFIED

SYSTEM TYPE

Floating

ANCHORAGE

No concrete attachment

SUBFLOOR CONSTRUCTION

Plywood Panel

RESILIENCE

Rezill 7/16" (11 mm) Pads

RECYCLED CONTRIBUTION



SportBond Plus Subfloor System includes components with recycled content

SLAB DEPRESSION

7/16" (11 mm) pad:
3/8" (10 mm) flooring – 1 7/8" (48 mm)
1/2" (13 mm) flooring – 2" (51 mm)
11/16" (17 mm) flooring – 2 1/8" (54 mm)

3/4" (19 mm) pad:
3/8" (10 mm) flooring – 2 1/8" (54 mm)
1/2" (13 mm) flooring – 2 1/4" (57 mm)
11/16" (17 mm) flooring – 2 3/8" (60 mm)

DIN STATUS



D·I·N

Meets or exceeds all the requirements of DIN 18032, part 2

TESTING LABORATORY



United States Sports Surfacing Laboratory

CERTIFIED TESTING



Laboratory test equipment calibrated and certified through the ISSS

GREEN STATUS

Managed forests, certification available

SPORTBOND PLUS WALL BASE DETAIL

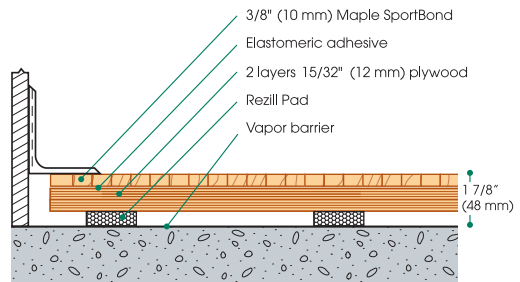

SPORTBOND WALL BASE DETAIL

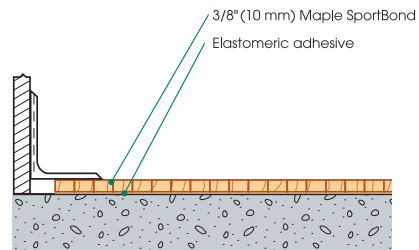

SPORTBOND FLEX WALL BASE DETAIL

