



DESIGNING  
MANUFACTURING  
INSTALLATION  
OF HIGH-END SPORTS EQUIPMENT





## History

Interplastic Roger Zoltowski is a private enterprise founded in 1985. We specialize in designing and manufacturing sports equipment for sport halls, arenas, school gyms, indoor and outdoor sport and leisure facilities. However INTERPLASTIC is also a producer of highest quality stainless steel furniture for food industry and display cases for biggest museums in Europe.

During over 30 years in sports business we have manufactured a countless number of items for thousands of clients.

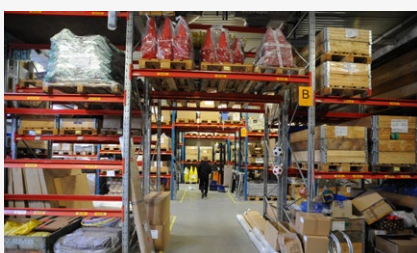

# WHO WE ARE AND WHAT WE DO



## Export

Our goods are exported to over 50 countries worldwide. Quality of our products is tested for compliance with polish and international safety standards which result in approvals issued by international sports federations.

It allows our products to be used during numerous worldwide competitions at the highest international level such as the European Championships (UEFA EURO 2012), World Championships (XXII Men's Handball World Championship 2011, FIVB Volleyball Men's World Championship 2014; IHF World Women's Handball Championship 2015) or even Olympic Games (Rio de Janeiro 2016).

## Domestic market

We are the leader in equipping outdoor and indoor sports facilities with complete range of sports equipment. Among our customers are sports federations, wholesalers, sub-contractors, schools, sports clubs and sports academies.

Apart from production we are also the official distributor of various well-known brands like Senoh, Schelde, Stramatel, Trial, Unihoc, Miracle Recreation and many others.

## Interplastic as a full service sports provider

Partners come with ideas of a product and our construction team returns with solutions. Providing drawings for the architects we help them to plan the object properly for the end user needs with the correct specification. Then we take care of production that can be executed with YOUR brand name. Our team can install or teach/supervise your installation team. During and after the guarantee period we provide maintenance and periodical services.

## Production

We have a modern production plant of 8500 sqm manufacturing in line with prevailing international standards and regulations. Our team of nearly 100 professionals is working in the areas of processing steel, aluminium, wood, upholstery, polyester resin laminates, glass and plastics.

We name ourselves professional OEM manufacturer that can develop and produce high quality customized products at a reasonable price.

## Location

Company location in centre of Europe in close neighbourhood of Gdynia and Gdansk sea ports and Gdansk International Airport, which makes all logistics arrangements smooth and customer friendly.

## Highest quality

The production line, employment standards, and products quality are in accordance to international standards. Before implementing, each new product is tested internally in order to provide highest quality and maximum safety for future users.

# INTERPLASTIC

## – complex service provider step by step

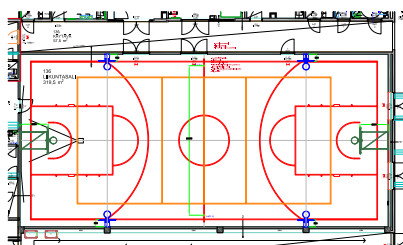

### Planning

Constructing and equipping of a sports hall requires several prior preparations and professional knowledge. Interplastic will help you to plan and coordinate the budget, build in possibilities and end user's needs. Thanks to appropriate preparations you can be sure, that the user will have only useful and safe devices.



### Designing

Our experienced team of constructors is trained to provide you advices and ready solutions adjusted to your project.

As we are working with Autodesk Inventor we are able to design and place the devices directly into provided AutoCAD files.

Flexibility is one of our strongest sites.



### Production

Over thirty years of manufacturing sports equipment and hundreds of thousands satisfied customers gives us the confidence, that we are doing a good job.

Our offer is very complex: Interplastic processes such materials like metals, wood, glass, epoxy resins and plastics. Currently, the total number exceed 5000 of different products.

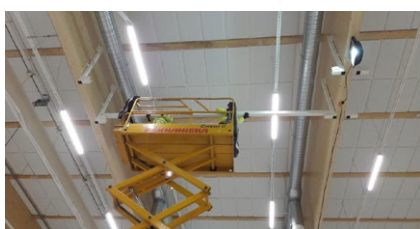

### Installation

For Interplastic's fitters team there are no limits. On our list of destinations, in which we provided full service including installation are such destinations like Middle East, Northern and Western Europe, Central Africa and many others.

If you are interested in a long term cooperation we could provide you a comprehensive training for your fitters in a place that is convenient for you.



### Aftersales

Interplastic provides services in range of post-warranty inspections and maintenance of sports equipment. Qualified service team will define condition of the device and if necessary will propose repair or replacement. All performed operations will be confirmed by a certificate stating, that the equipment is now allowed for further usage and safe for the users.



# WHY TO CHOOSE INTERPLASTIC

## Certificates

INTERPLASTIC means highest quality and maximum safety. In order to be absolutely sure, that all our products are made in accordance to applicable norms and safety rules, they were tested and approved by several international institutions, like in example TUV Austria, Polish Sports institute and The Standards Institution of Israel and others.

The range of tests includes also periodical check-ups of our production line, so the customer can be sure, that we are not making any major changes in the products without appropriate permissions.



## Internal control

Before a new item is implemented in the offer, it goes through several demanding internal tests, which are performed on our testing ground. This gives us the confidence, that the final product is absolutely safe for the future users.



## Experience

One of our advantages is more than 30 years of experience in designing, manufacturing and installing sports equipment. The knowledge gained during all this year in business gives us a self-confidence when dealing with difficult or almost impossible challenges.



## We choose only proven partners

Interplastic chooses only solid providers, which can improve our products with knowledge and highest quality resources. Partnerships with local subcontractors allows us to provide also services like zinc and hot galvanizing, powder-coating, anodizing, chrome plating and many others.

## INTERPLASTIC RECOMMENDS:

Products from the range of football, handball and volleyball are made of special designed aluminum profiles provided by:

FINAL S.A. based in Poland ([www.final.pl](http://www.final.pl)).





# BASKETBALL



## CEILING SUSPENDED UNITS

- Simple and long lasting steel structure
- Adaptable for most of sports halls with height from 6 to 9 m
- Made in compliance with FIBA and EN 1270 norms
- Easy and quick to deploy
- Maintenance free
- 60 months warranty for metal structure

Ceiling suspended construction. Made of steel profiles, protected against corrosion by powder-coating. Electrically operated with use of an engine [single-phase, 230V; 120 Nm]. Controlled by a provided key switch. Additional break [load arrestor] provides maximum safety in case of an engine failure. Thanks to applied retracting belts construction works quiet and smooth.

Option: manual height regulation mechanism [260-305 cm].

Installation: concrete, wooden or steel ceiling structures.

Designed for: 180x150 cm / 120x90 cm; acrylic / tempered glass / laminate backboards.

**BB101.01**

## WALL MOUNTED, UP-FOLDED BASKETBALL UNITS

- Easy to install – the only requirement is a sufficient, flat, concrete surface
- Standard projections: 1,25; 2,25; 3,25 and 4,25 m. Customized lengths upon request
- Easy and quick to deploy
- Maintenance free
- 60 months warranty for metal structure
- Powered with standard single-phase motor (230V; 50-60 Hz)

Wall mounted basketball construction. Folded up [on the wall] with use of a motor. Made of steel profiles protected against corrosion by powder-coating. Single-phase engine powered with standard 230V, 50-60 Hz power supply, hidden in a special designed galvanized console, installed on a pair of wall brackets. Provided with heavy duty chains. Thanks to applied retracting belts construction works quiet and smooth.

Additional break [load arrestor] provides maximum safety in case of an engine failure.

Option: manual height regulation mechanism [260-305 cm].

Installation: only on solid concrete walls. It is required to use adhesive anchors and threaded rods for the installation of engines', chains' and safety brake's brackets.

Designed for: 180x150 cm / 120x90 cm; acrylic / tempered glass / laminate backboards.

**BB101.02**







## WALL MOUNTED UNITS

- Super durable constructions
- Projections from 0,8 up to 2,45 m
- Made in compliance with EN 1270 norm
- Easy and quick to operate
- Maintenance free



Wall mounted basketball construction.

FOLDABLE **BB101.03**

FIXED **BB101.04**

Made of steel profiles, protected against corrosion by powder-coating. Manually operated with use of a provided hook.

Option: height regulation mechanism (260-305 cm).

Installation: concrete walls or pillars.

Designed for: 180x150 cm / 120x90 cm; acrylic / tempered glass / MDF / laminate backboards.



## FIXED CONSTRUCTIONS WITH INTEGRATED HEIGHT REGULATION (TRAINING UNIT)

- Very easy to install and operate
- Projection 0,5 m
- Made in compliance with EN 1270 norm
- Integrated height mechanism
- Maintenance free

Wall mounted fixed construction . Made of steel profiles protected against corrosion by powder-coating. Manually operated with use of a provided hook. Integrated manual height regulation mechanism (260-305 cm).

Installation: concrete walls or pillars.

**BB101.05**

# ACCESSORIES



## DUNK RING PRO

Professional dunk ring. Made of steel, in accordance to EN 1270. Color RAL 2002 (blood orange).

- Double layer of coat prevents corrosion (outdoor use available)
- safe (no hooks) net attachment type (in 12 points, provided with stainless steel rod)
- tensioning springs adjustable
- mounting holes in accordance to EN 1270
- ring made of full, 18 mm rod

**BB102.01.01**



## DUNK RING STD

Training dunk ring. Made of steel, in accordance to EN 1270. Color RAL 2008 (orange).

- Double layer of coat prevents corrosion (outdoor use available)
- safe (no hooks) net attachment type (in 12 points, provided with stainless steel rod)
- mounting holes in accordance to EN 1270
- ring made of 18 mm pipe

**BB102.01.02**



## FIXED RING STD

Standard basketball ring. Made of steel. 12 hooks for attaching the net. Suitable for indoor use.

**BB102.01.03**

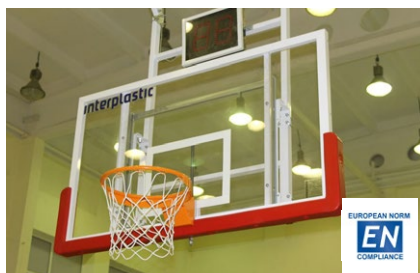

## TEMPERED GLASS BACKBOARD 180X105 CM

180x105 CM TEMPERED GLASS BACKBOARD on a support steel, powder coated frame. Meets FIBA standards. Thickness of the glass 10 mm. Due to its unique construction, the ring is installed directly to the support structure extending product life (heavy dunks resistant). Target zone lines in accordance to EN 1270.

**BB102.02.01**



## ACRYLIC BACKBOARD

180X105 CM ACRYLIC BACKBOARD on a support steel, powder coated frame. Thickness of the glass 10 mm. Due to its unique construction, the ring is installed directly to the support structure extending product life (heavy dunks resistant). Target zone lines in accordance to EN 1270.

**BB102.02.02**

120x90 CM ACRYLIC BACKBOARD on a steel, powder coated frame. Thickness of the glass 10 mm. Due to its unique construction, the ring is installed directly to the support structure extending product life (heavy dunks resistant). Target zone lines in accordance to EN 1270.

**BB102.02.03**

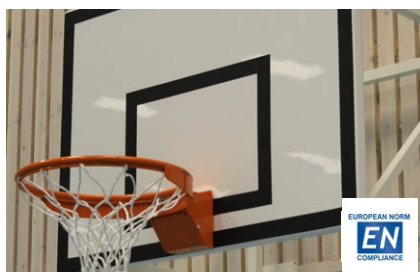

## EPOXY LAMINATED BACKBOARD

180X105 CM EPOXY LAMINATED BACKBOARD on a support steel, powder coated frame. Mounting holes and target zone lines in accordance to EN 1270.

**BB102.02.04**

120x90 CM EPOXY LAMINATED BACKBOARD on a support steel, powder coated frame. Mounting holes and target zone lines in accordance to EN 1270.

**BB102.02.04**



## PU BOTTOM EDGE SAFETY PAD

Heavy duty polyurethane foam padding for tempered glass and acrylic backboards. Installed with use of bolts and screws (both provided). Outdoor and indoor use possible.

Available in:

180x105 cm	BLUE	<b>BB102.03.01</b>
	RED	<b>BB102.03.02</b>
	GREEN	<b>BB102.03.03</b>
	BLACK	<b>BB102.03.04</b>

120x90 cm	BLUE	<b>BB102.03.05</b>
	RED	<b>BB102.03.06</b>



## EVA BOTTOM EDGE SAFETY PAD

EVA foam padding for acrylic backboards. Installed with use of bolts and screws (both provided). Outdoor and indoor use possible.

Available in:

180X105 cm	BLUE	<b>BB102.03.07</b>
	RED	<b>BB102.03.08</b>
	GREEN	<b>BB102.03.09</b>
120x90 cm	BLUE	<b>BB102.03.11</b>
	RED	<b>BB102.03.12</b>
	GREEN	<b>BB102.03.13</b>

## POLYPROPYLENE NET

Polypropylene net, 5 mm thick, 12 points of attachment, white. **BB102.04.01**

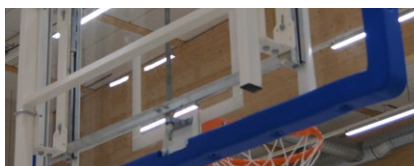

## HEIGHT REGULATION MECHANISM

Manual height regulation mechanism. Gives the possibility to set up the ring height on 260 or 305 cm from the floor.

**BB102.05**



## LOAD ARRESTOR (reccomended for ceiling and wall suspended units)

Safety device, that prevents from accidents in case of an engine, belt, steel wire or any other consumable elements failure.

Constructions up to 140 kg: **BB102.06.14**

Constructions up to 300 kg: **BB102.06.30**





## FIVB OFFICIAL SET FOR VOLLEYBALL - SENOH

- Designed for highest level competitions, including such events like Olympic Games, World League or World Championships.
- Solid, proven items, tested during several events since Olympic Games in 1964
- FIVB OFFICIAL certificate

**Senoh**

**FIVB**  
FÉDÉRATION INTERNATIONALE  
DE VOLLEYBALL



EUROPEAN NORM  
**EN**  
COMPLIANCE

### VB201.01 Volleyball uprights

[special designed steel profile 76,3x5,15 mm, powder coated in red]. Designed for indoor use, telescopic height adjustment. Weight: 60 kg/pair. Senoh ref. DE1015

### VB202.01.01 Safety pads

Designed for indoor use, made of urethane foam. Weight: 16 kg/pair. Standard color: blue. Senoh ref. **DE2000**



### VB202.02 Net

Designed for indoor use, made of polyethylene, with technora cable. Dimensions: 9500x1000 mm. Mesh: square, 100x100 mm. Senoh ref. DE8003

### VB202.04 Antennae

Made of fiberglass. Weight: 1,2 kg. Senoh ref. **DE9411**



### VB203.01 – ground sockets

Made of steel with special designed aluminum alloy, integrated lid. Designed for suspended sports floors [on a wooden sub-structure]. Senoh ref. **KD0140**

### VB203.02 - ground sockets

Made of steel with special designed aluminum alloy, integrated lid. Designed for non-suspended sports floors [synthetic glued directly to concrete]. Senoh ref. **KD0141**



## VB202.03.01 – referee stand

Made of steel, painted in red. Stand has a height regulation mechanism and pads protecting whole construction. Equipped with wheels for easy transport. Weight: 125 kg. Senoh ref. [DL0520](#)



## PROFESSIONAL VOLLEYBALL UPRIGHTS 80x80 MM

- Made in compliance with EN 1271 norm - Type 1, class B
- Designed for indoor and outdoor use

Professional volleyball uprights [type 1 class B according to EN 1271]. Made of special designed [internally reinforced] aluminum profile 80x80 mm. Tensioning apparatus is hidden inside the profile. Uprights are protected against corrosion by powder-coating [in red RAL 3020 color]. Length of a single upright: ~ 3 m. The set contains:

- Upright with tensioning apparatus
- Upright with net attachments
- Crank handle

Height of the net is regulated smoothly, and tensioning apparatus/passive net attachments are blocked eccentricity. This feature allows to use uprights also for tennis and badminton.

[VB201.02](#)

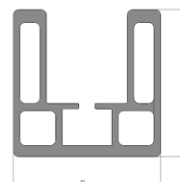

## TRAINING VOLLEYBALL UPRIGHTS 100 MM

- Made in compliance with EN 1271 norm - Type 1, class C
- Designed for indoor and outdoor use

Training volleyball uprights [type 1 class C according to EN 1271]. Made of special designed [internally reinforced] aluminum profile with diameter of 100 mm. The shape of the profile allows to use as a middle upright. Uprights are protected against corrosion by anodizing [natural aluminum color]. Length of a single upright: ~ 3 m. The set contains:

- Upright with tensioning apparatus
- Upright with net attachments
- Crank handle

Height of the net is regulated smoothly, and tensioning apparatus/passive net attachments are locked with use of a single knob. This feature allows to use uprights also for badminton.

[VB201.03](#)

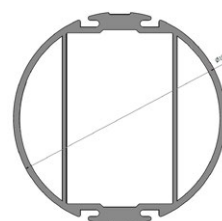



# Volleyball – Accessories

## GROUND SOCKETS



Stainless steel socket for 80x80 mm profile. Internal dimension: 82x82 mm, depth 335 mm. Designed for indoor use and for suspended sport floors [on a wooden sub-construction].

**VB203.03**



Steel socket for 100 mm profile. Internal dimension: 102 mm, depth 300 mm. Designed for indoor [for suspended sport floors - on a wooden sub-construction] and outdoor use.

**VB203.04**



Stainless steel socket for 100 mm profile. Internal dimension: 102 mm, depth 300 mm. Designed for indoor use for non-suspended sport floors [floors directly on concrete]. Provided together with integrated floor frame and Plexiglas lid.

**VB203.05**

## NETS

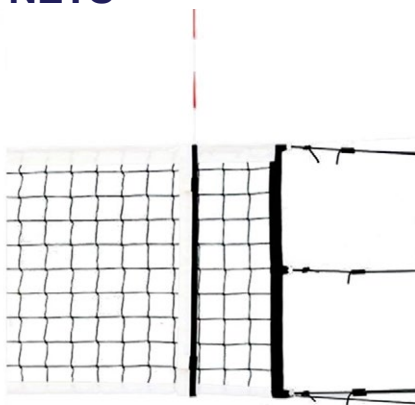

### PROFESSIONAL VOLLEYBALL NET

Professional volleyball net. Upper cable made of Kevlar, 11.7 m length, upper tape 7 cm wide, lower tape 5 cm. 6 point assembly to uprights. Made of polypropylene, colour black, 3 mm thickness, mesh size 10x10 cm

**VB204.01.01**

### TRAINING VOLLEYBALL NET

Training volleyball net. Upper cable made of steel, upper tape 5 cm wide, 4 point assembly to uprights. Made of polypropylene, colour black, 3 mm thickness, mesh size 10x10 cm. Antennae's with pockets included.

**VB204.02.01**

Net antennae set with pockets, made of fiberglass. Dimensions and colour due to FIVB game rules. VB204.03

## OTHERS

### FOLDABLE REFEREE'S STAND

Description:

- Made of steel, protected against corrosion by powder-coating
- Anti-slip platform made of rifled aluminum
- Backrest made of water resistant plywood
- Available in indoor and outdoor version
- 3 heights of the platform
- Equipped with wheels
- Installation possible to any volleyball upright [with use of Velcro tapes]

Usage	Color (RAL)
Indoor	Red (3020)
Outdoor	Yellow (1021)

Code  
**VB202.03.02**  
**VB202.03.03**





### SUBSTITUTION PADDLES IN BOX

Substitution paddles made of PVC [pad] and PMMA [handle]. Set for two competing teams, safe storage in boxes. Paddles separated in box for easy and quick handling. Colors:

Boxes – white

Paddles – white with black numbers

Numbers

1-20

1-22

1-24

Code

[VB202.05.20](#)

[VB202.05.22](#)

[VB202.05.24](#)

## PROTECTION PADS FOR UPRIGHTS



### PROFESSIONAL VOLLEYBALL UPRIGHTS PROTECTING PADS

Filled in with polyethylene foam [water resistant] app. 3 cm thick, density app. 100 kg/m<sup>3</sup>. Covered with UV and water resistant PVC. Solid plywood construction, mounted by Velcro tapes to uprights.

[VB202.01.02](#)



### STANDARD VOLLEYBALL UPRIGHTS PROTECTING PADS

Filled in with polyethylene foam [water resistant] app. 3 cm thick, density app. 100 kg/m<sup>3</sup>. Covered with UV and water resistant PVC.

[VB202.01.03](#)

### FLOOR FRAME WITH PLEXIGLASS LID

- Clear [VB202.06](#)
- Oak [VB202.06.01](#)
- Beech [VB202.06.02](#)
- Maple [VB202.06.03](#)







## IHF APPROVED HANDBALL GOALPOSTS

- Designed for highest level competitions, including such events like Olympic Games or World Championships.
- Made in compliance with EN 749 and IHF requirements
- Available in BOX version - packed into single carton – transport and storage has never been so easy



Handball goalpost 3,00x2,00 m, with certificate of approval issued by the International Handball Federation. Complies with EN 749. Type 2 [anchored to pre-installed ground plates with use of rubber screws]. Internally reinforced aluminum frame [80x80 mm], powder coated in white [RAL 9003] and black/blue/red stripes [RAL 9005/5010/3020]. Frame consist two uprights, a crossbar with welded corners and two special designed aluminum connectors. The net support is made of steel tubes [ø35x2 mm] powder coated in white [RAL 9003]. Total depth of the goalpost: 100/130 cm [top/bottom]. The construction of the net support allows to fold it without using any hand tools. Steel winches, struts and screws are protected against corrosion by zinc galvanization.

Assembly tools, ground plates, rubber screws, net hasps and hitches included in set.



## NOW AVAILABLE ALSO AS „GOAL IN A BOX” VERSION!

BOX version main features:

- Main frame, net support and net packed into single carton
- manufactured and supplied by Interplastic to the 2016 Summer Olympics
- card box dimensions: 318x23x14 cm, weight 55 kg
- unique, patented net support construction
- up to 16 pcs on a single pallet

3x2 m IHF approved HB goal STD TYPE 2 ACCORDING TO EN 749 [HB301.01](#)

3x2 m IHF approved HB goal BOX TYPE 2 ACCORDING TO EN 749 [HB301.02](#)







## STANDARD AND MINI HANDBALL GOALPOSTS AVAILABLE IN CLASSIC AND “BOX” VERSIONS

- Made in compliance with EN 749 norm
- Type 1 □ uprights installed in sleeves □ designed for outdoor use
- Type 2 □ anchored to the surface with ground plates □ designed for indoor use
- Depths are customizable
- Available in standard (3x2 m) and mini (2,4x1,6 m) dimensions

3x2 m [2,4x1,6 m for mini handball] handball goals designed for professional handball arenas as well as for schools and training purposes.

All goals are made in accordance to EN 749 norm.

Painted stripes in several color versions [no stickers] extends products life.

No steel hooks used [for maximum safety]. The net is attached to the frame with plastic hasps and hitches.

Easy to fold and store [no tools are needed to unscrew the goal from the surface and to fold its net support].

### Aluminum goal type 1:

- Goal frame: internally reinforced 80x80 mm aluminum profile, powder coated twice [base layer + stripes]
- Net support: steel, hot galvanized tubes
- Mounting system: socket
- Frame dimensions: 3x2 m
- Standard total net support depth [top/bottom]: 90/110 cm
- Corners reinforcement and struts: solid, laser cut and zinc galvanized steel
- Frame consist 2 uprights and 1 crossbar [with welded corner], joined together by special aluminum connector
- Net installed with use of plastic hasps and hitches

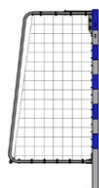

### Aluminum goal type 2:

- Goal frame: internally reinforced 80x80 mm aluminum profile, powder coated twice [base layer + stripes]
- Net support: steel, powder-coated [white RAL 9003] tubes
- Mounting system: with use of safety [rubber] screws to pre-installed ground plates
- Frame dimensions: 3x2 m [mini: 2,4x1,6 m]
- Standard total net support depth [top/bottom]: 90/110 cm
- Corners reinforcement and struts: solid, laser cut and zinc galvanized steel
- Frame consist 2 uprights and 1 crossbar [with welded corner], joined together by special aluminum connector
- Net installed with use of plastic hasps and hitches



3x2 m HB goal STD	<a href="#">HB302.01</a>
3x2 m HB goal BOX	<a href="#">HB302.02</a>
3x2 m HB goal STD	<a href="#">HB303.01</a>
3x2 m HB goal BOX	<a href="#">HB303.02</a>
2,4x1,6 m HB goal STD	<a href="#">HB304.01</a>





## FOLDED HB GOALPOST

User friendly – operated with a single button/key  
 Timesaving solution – no need for manual dismounting the goal and putting it to the warehouse  
 Special usability – goal do not obstruct the arena when not in use  
 Storage – no warehouse space needed  
 Design – adapted individually for indoor sport facilities  
 Safety – self-retracting brake included

- Goal frame: internally reinforced 80x80 mm aluminum profile, double powder coated (base layer + stripes)
- Goal construction: wall mounted, steel, powder coated in a color adequate to conditions at the hall
- Drive: Somfy engine (230V, 50-60 Hz) in a console
- Maintenance: remote/key switch/steering box
- Net: special net with ballast cord and ball catcher, made of knotless polypropylene min. 4 mm thick, mesh 10x10 cm

Goalpost [1 unit with support structure]  
 Load arrestor [up to 140 kg]  
 Net for mechanically winched handball goal with a special ballast cord.

[HB305.01](#)

[BB102.10.14](#)

[HB305.02](#)

## HANDBALL GOALS' NETS

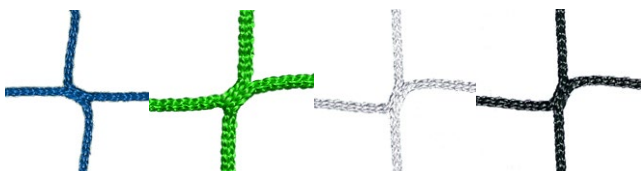

## TRANSPORT TROLLEY FOR GOALPOSTS

Set of two trolleys, made of stainless steel. Equipped with rubber wheels. Indoor use only.

[HB307.01](#)



## INDOOR USE POLYPROPYLENE NETS

Parameters:

- mesh 100x100 mm
- material: knotless polypropylene
- dimensions: width 310 cm, height 210 cm, depth: 80x100 cm
- colors available: white, black, yellow and blue
- edges reinforced with special cord

Thickness available:

3 mm

[HB306.03](#)

4 mm

[HB306.04](#)

5 mm

[HB306.05](#)

# BADMINTON AND TENNIS

## PROFESSIONAL BADMINTON STANDS

- Made in accordance to EN 1509 (Type 3 class A)
- Counterweight approximately 60 kg per single stand (120 kg total)
- Indoor use
- Equipped with tensioning apparatus
- Potable (on wheels)
- Made of steel, protected against corrosion by powder-coating

Color	RAL	Code
RED	3020	<b>BT401.01</b>
BLUE	5010	<b>BT401.02</b>



## TRAINING BADMINTON STANDS

- Made in accordance to EN 1509 (Type 3 class C)
- Counterweight approximately 30 kg per single stand (60 kg total)
- Indoor and outdoor use
- Portable (on wheels)
- Made of steel, protected against corrosion by powder-coating
- Easy transport and storage thanks to its construction (3 separate parts, connected together with screws )

Usage	Color	RAL	Code
Indoor	Red	3020	<b>BT402.01</b>
Outdoor	Blue	5010	<b>BT402.02</b>

## TENNIS POSTS

- Made in accordance to EN 1510
- Made of internally reinforced aluminum profile (80x80 mm)
- Powder-coated in green (RAL 6009)
- Internally hidden tensioning apparatus and crank

**TN501.01**







## IFF APPROVED FLOORBALL GOALS



IFF approved floorball goal. Made of steel, protected against corrosion by powder-coating in red (RAL 3020). Provided with net (polypropylene, mesh 45x45 mm, 3 mm thick, ball catcher with ballast cord).

RAL	Type	Code
3020	115x160 cm fixed	<b>FB603.01.01</b>



## IFF APPROVED FLOORBALL RINK



- Dimensions: 40x20 m
- Epoxy laminated rink system
- Delivered with two storage trolleys made of powder-coated steel
- Available in white or black color
- IFF certificate of approval

Color	Code
WHITE	<b>FB60101.01</b>
BLACK	<b>FB60102.01</b>



## TRAINING FLOORBALL EQUIPMENT

### GOALS

Dimensions	Color	Code
45x60 cm Telescopic	White	<b>FB603.01.06</b>
45x60 cm Collapsible	Red	<b>FB603.01.05</b>
60x90 cm Collapsible	White	<b>FB603.01.04</b>
105x140 cm Collapsible	White	<b>FB603.01.03</b>
115x160 cm Collapsible	White	<b>FB603.01.02</b>

### Rink

(including transport/storage trolley)

Dimensions	Color	Code
30x15 m	White	<b>FB60101.02</b>
30x15 m	Black	<b>FB60102.02</b>
20x10 m	White	<b>FB60101.03</b>
20x10 m	Black	<b>FB60102.03</b>

[i] Other dimensions upon request

# GYMNASTICS

## CEILING SUSPENDED RINGS CONSTRUCTION

- Designed for one, two, three or four pairs of rings
- Delivered with professional, wooden rings with certified belts (28 or 32 mm diameter)
- Made in compliance with EN 12655 norm
- Easy and quick to use
- Maintenance free
- 60 months warranty for metal structure

Construction for 1 pair of rings

Construction for 2 pairs of rings

Construction for 3 pairs of rings

Construction for 4 pairs of rings

Professional wooden rings, diameter 28 mm

Professional wooden rings, diameter 32 mm

[GM701.01.01](#)

[GM701.01.02](#)

[GM701.01.03](#)

[GM701.01.04](#)

[GM701.02.28](#)

[GM701.02.32](#)

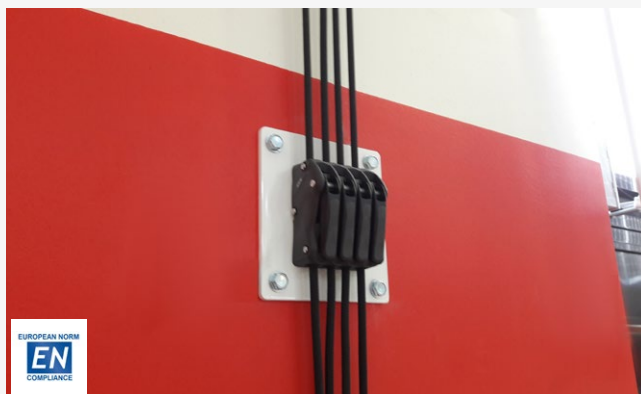

Ceiling suspended construction for hanging gymnastic rings. Made of steel profiles, in accordance to EN 12655 norm. Protected against corrosion by powder-coating. Standard color of the structure: white. Provided with:

- Professional rings 28 or 32 mm thick, diameter in accordance to EN 12655, on certified belts
- Special locking device for ropes, on a mounting plate
- Certified climbing rope, 10,5 mm thick
- An appropriate amount of steel ballasts [each app. 1,5 kg] to make the rings go down easily

Installation: concrete, wooden or steel ceiling structures.



## CEILING SUSPENDED ROPES' RAIL

- Designed for from 2 up to 6 ropes.
- Made in compliance with DIN 7911-2:1998-12
- Provided with ropes made of natural fibers (length 3-6,5 m)

Construction for 2 climbing ropes

**GM702.01.02**

Construction for 3 climbing ropes

**GM702.01.03**

Construction for 4 climbing ropes

**GM702.01.04**

Construction for 5 climbing ropes

**GM702.01.05**

Construction for 6 climbing ropes

**GM702.01.06**

Climbing ropes (length in m):

3,0	<b>GM702.02.01</b>	3,5	<b>GM702.02.02</b>
4,0	<b>GM702.02.03</b>	4,5	<b>GM702.02.04</b>
5,0	<b>GM702.02.05</b>	5,5	<b>GM702.02.06</b>
6,0	<b>GM702.02.07</b>	6,5	<b>GM702.02.08</b>



Ceiling suspended construction with rail for hanging climbing ropes.

Made of steel profiles, in accordance to DIN 7911-2:1998-12. Protected against corrosion by powder-coating. Standard color of the structure: white.

Provided with:

- Ropes made of natural fibers, length between 3 and 6,5 m
- Wall storing console for ropes
- Safety lock, which disables to fold the ropes accidentally

Installation: concrete, wooden or steel ceiling structures.

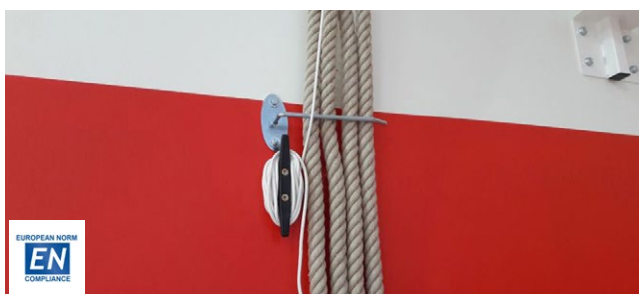

## WALL BARS

- Customized dimensions, height up to 3 m
- Available in single or double version (width up to 1 m for single and 2 m for double)
- Possibility to replace damaged stave thanks to using screws instead of nails
- Made in accordance to EN 12346

Wooden wall bars (gymnastic ladders), made in compliance to EN 12346. Staves made of plywood (40x30 mm), sides of pine (100x30 mm). Elements connected together with use of screws. Lacquered with use of transparent, non-toxic paint. Wall bars are provided with installation accessories like standard "T" shaped grips or beam system (in order to install the ladders i.e. between pillars or 10 cm above the floor). Available versions:

- Single – height up to 3 m, width to 1 m
- Double – height up to 3 m, width to 2 m

Standard dimension available:

Single (width 0,75 m)	Height: 2,56 m	<b>GM703.01.01</b>
	Height: 3,00 m	<b>GM703.01.02</b>
Single (width 0,9 m)	Height: 2,56 m	<b>GM703.01.03</b>
	Height: 3,00 m	<b>GM703.01.04</b>
Double (width 1,5 m)	Height: 2,56 m	<b>GM703.02.01</b>
	Height: 3,00 m	<b>GM703.02.02</b>
Double (width 1,8 m)	Height: 2,56 m	<b>GM703.02.03</b>
	Height: 3,00 m	<b>GM703.02.04</b>

Other dimensions upon request



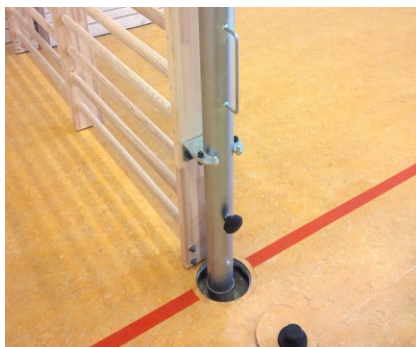

## FOLDABLE (PIVOTING) WALL BARS

Pivoting wall bars including:

- Double wall bar (180x256 cm – other upon request) made of solid pine (vertical elements) and plywood (staves); both lacquered with transparent, non-toxic paint
- Wall fixings made of steel, zinc galvanized
- Vertical upright (steel, zinc galvanized) with fixings and locking elements
- Ground socket

**GM703.03**

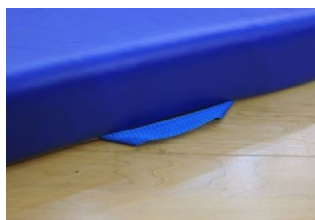

## GYM MATS

Cover – stitched, made on the top and on the sides of one side coated material PVC. The bottom of the mat made of anti-slip material.

Foam – high quality, flexible polyurethane, re-foamed foam at four densities: R-80 kg / m<sup>3</sup>, R-100 kg/m<sup>3</sup>, R-120 kg/m<sup>3</sup> and polyurethane foam T25kg/m<sup>3</sup>.

Accessories:

- reinforced corners – made of PVC material or natural leather (to protect the most weak parts of the mat),
- Hand grips for easy carrying mats

Available in following dimensions:

200x120x5 cm

200x120x10 cm

200x120x20 cm

Other dimensions upon request.

**GM704.05**

**GM704.10**

**GM704.20**

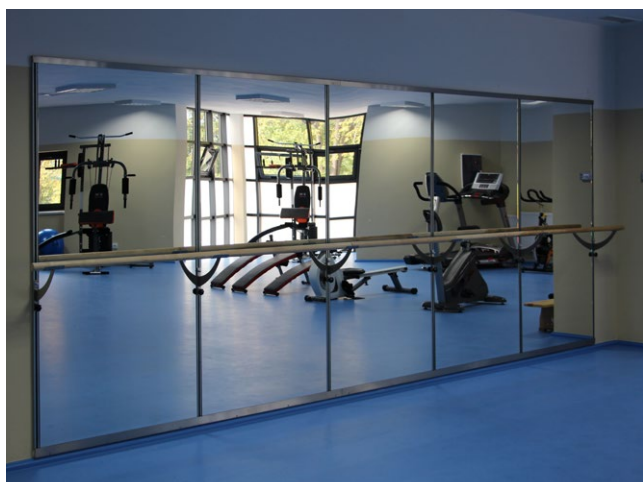

## MIRRORS AND BALLET BARS

Mirrors 2x1 m

Ballet bar holder (single) – powder coated steel

Ballet bar holder (single) – stainless steel

Ballet bar holder (double) – powder coated steel

Ballet bar holder (double) – stainless steel

Ballet bar made of ash or beech (in m)

**GM705.05**

**GM705.01.01**

**GM705.01.02**

**GM705.02.01**

**GM705.02.02**

**GM705.06**





## WALL/UPRIGHTS' PADDING

Custom made paddings for pillars, walls and corners.

- Available in several colors (yellow, red, green, blue, red, orange, navy blue)
- Height: up to 2 m
- Thickness: 3, 5, 10, 15 or 20 cm
- Installed with use of Velcro tapes
- Customized shapes and hardness (foam density)

**GM704.01**

## GYMNASTIC BENCHES WITH WOODEN LEGS

Made of solid wood, varnished with transparent, non-toxic paint. Wooden legs with robber foots.

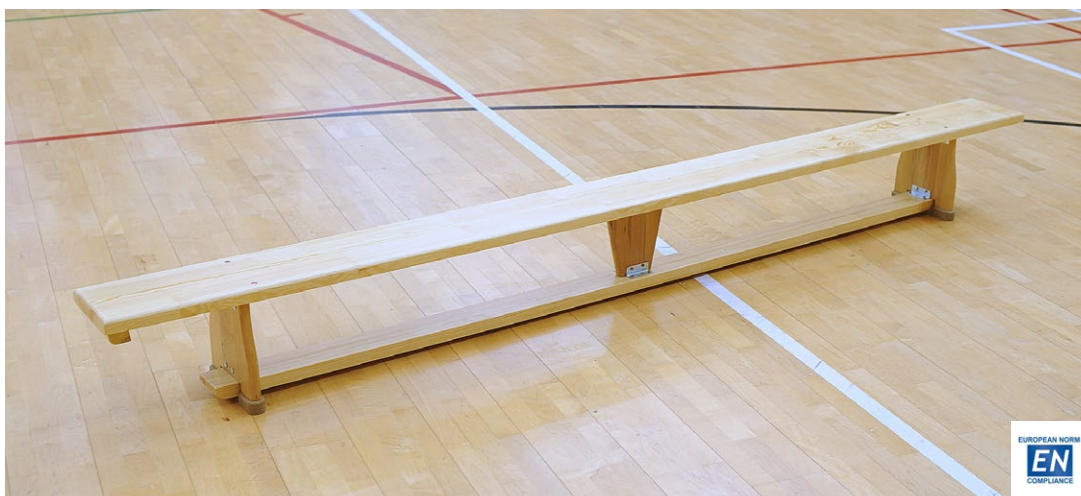

Length	Code
2 m	<b>GM708.02</b>
4 m	<b>GM708.04</b>
3 m	<b>GM708.03</b>
5 m	<b>GM708.05</b>



Length	Code
2 m	<b>GM709.02</b>
4 m	<b>GM709.04</b>
3 m	<b>GM709.03</b>
5 m	<b>GM709.05</b>



## GYMNASTIC DEVICES



### SPRING BOARD SCHOOL

Springboard Standard. Made of special shaped plywood, covered with carpet lining. Extra microporous rubber absorbent increases elasticity. 1200x600 mm, height at front 150 mm.

**GM710.01**



### VAULTING BUCK

Vaulting buck, corpus made of glued softwood, compounded foam upholstered with natural or artificial leather. Base made of solid steel profiles, powder coated. Height adjustment between 110 and 170 cm every 5 cm. Legs protected by anti-slip hooves, two legs equipped with wheels for easy transportation. Complies with EN 12196 standard.

**GM710.02**



### VAULTING BOX

Vaulting box, 5 segments, 2-wheels trolley, covering made of natural or artificial leather. Box segments made of plywood, corners and tenons of hardwood. Gluing connections assure high rigidity of each segment and tenons assure stability of the whole box. Lower segment with anti-slip feet. Complies with EN 913 standard.

**GM710.03**

## HORIZONTAL BARS

- Customized configurations available
- Light, aluminum uprights with diameter of 100 mm
- Provided with stainless steel sockets
- Made in accordance to EN 12197



### FREESTANDING HORIZONTAL BAR WITH WALL CONSOLE

Horizontal bar, socketed, single or double-field. Set contains:

- Uprights made of anodized aluminum round profile (Ø100, wall thickness 5 mm), 19 levels of height adjustment in 10 cm increments [bar height 80-260 cm].
- Wall console made of steel, protected against corrosion by powder-coating in RAL 9006 color
- ground sockets made of stainless steel [ANSI 1.4305, Ø108, depth 472 mm],
- socket clamping device, horizontal bars made of steel Ø28 mm, with fork head on both sides
- securing wedges



### FREESTANDING HORIZONTAL BAR

Horizontal bar, socketed, single or double-field. Uprights made of anodized aluminum round profile (Ø100, wall thickness 5 mm), 19 levels of height adjustment in 10 cm increments [bar height 80-260 cm]. Set includes: ground sockets made of stainless steel [ANSI 1.4305, Ø108, depth 472 mm], socket clamping device, horizontal bars made of steel Ø28 mm, with fork head on both sides and securing wedges.

STANDARD DIMENSION AVAILABLE:

Wall/upright

Upright/upright

Wall/upright/upright

Upright/upright/upright

[i] Other configurations upon request

**GM704.01.21**

**GM704.01.11**

**GM704.02.21**

**GM704.02.11**





# SPORTS HALLS' AND STORAGE EQUIPMENT



## DIVIDING CURAINS

- Designed for heavy, PVC curtains
- Safety brake in standard
- 3-phase motor 400V, 300 Nm
- Max. width: 40 m

Construction for mounting and vertical lifting dividing curtain. Electrically operated with use of a steering box mounted on a wall or remote controller. Steel elements protected against corrosion with powder-coating / zinc galvanizing. Mounted to a steel beam (80x80 mm or similar). The curtain is operated by electrical motor equipped with safety switches. Electrical mechanical safety brakes prevent uncontrolled curtain slips.

The curtain is pulled up with use of polyester belts placed in axial distance of approximately 200 cm.

Dividing curtain: grey (other colors upon request), non-transparent polyester fabric is UV resistant coated with PVC on both sides, microbiologically resistant, fire resistant according to DIN 4102 B1. Weight: 900 g/m<sup>2</sup>. Height of the PVC: up to 2,5 m.

Above the PVC: polypropylene net mesh 100x100 mm, thickness 3 mm, color white or black.

Contains system of strengthening and stabilizing steel/aluminum pipes.

**SH801.01**



## LOCKER ROOM

Main features:

- Wide range of models and additional accessories available
- Several color options offered
- Delivered with cam locks, padlocks, keypads or coin locks
- Solid, ergonomic construction
- Customization possible – i.e. client's logo as perforation (vent)



**"L" type locker**  
**SH802.01**



**Locker with/on a bench**  
**SH802.02**



**Multi-tier locker**  
**SH802.03**



### One-sided bench for locker rooms.

Steel [powder-coated] frame with wooden [transparent lacquer].  
Provided with hooks. Standard length: 2 m [other upon request].  
Double-sided bench for locker rooms.

**SH803.01**

Steel [powder-coated] frame with wooden [transparent lacquer].  
Provided with hooks. Standard length: 2 m [other upon request].

**SH803.02**



## STORAGE EQUIPMENT



### Trolley for transport and storage of one pair of volleyball uprights.

Suitable for all types and lengths.  
Made of steel, protected against corrosion by powder coating in black [RAL 9005].  
Equipped with 4 rubber wheels [two with brakes] and a hook for net hanger.

**SE901.01.01**

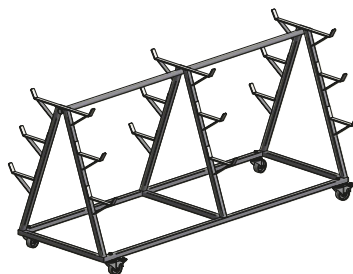

### Trolley for transport and storage of one pair of volleyball uprights.

Suitable for all types and lengths.  
Made of steel, protected against corrosion by powder coating in black [RAL 9005].  
Equipped with 4 rubber wheels [two with brakes] and a hook for net hanger.

**SE901.01.03**

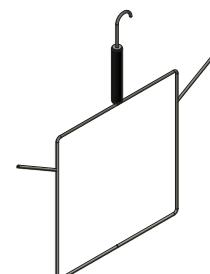

### Net hanger (for one volleyball / badminton / tennis net).

Protected against corrosion by powder coating in black or zinc galvanization.  
Equipped with handle.

**SE901.01.02**



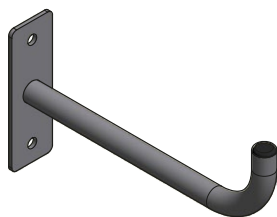

#### Standard (universal) hook.

Made of steel, available in lengths: 15 and 30 cm] other upon request]. Protected against corrosion by powder-coating in black (RAL 9005). Designed for hanging gymnastic hoops, sashes, nets, rings and many others.

15 cm  
30 cm

[SE902.01.15](#)  
[SE902.01.30](#)

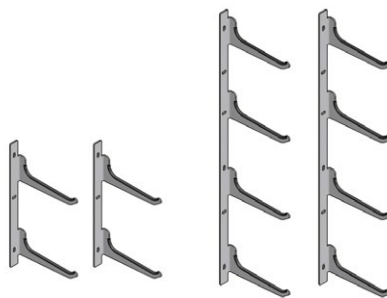

#### Wall storage console for posts.

Suitable for any uprights (volleyball, horizontal bars, etc.). Including anti-scrap

Available in two versions:

2x2 hooks

[SE902.02.02](#)

[8 uprights with max diameter of ~100 mm]

2x4 hooks

[SE902.02.04](#)

[4 uprights with max diameter of ~100 mm]

Protected against corrosion by powder-coating in black (RAL 9005).



#### Wall console for storing nets hangers.

Protected against corrosion by powder-coating in black (RAL 9005).

Capacity: 6-8 hangers.

[SE902.03](#)

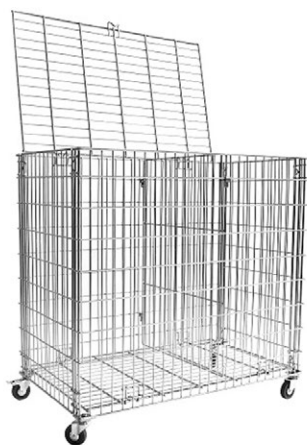

#### Storage trolley for balls and other sports equipment

Heavy-duty trolley made of steel rods, protect against corrosion by zinc-galvanization. Equipped with rubber wheels [two with brake] and a partition. Easy for transport – foldable.

Dimensions: 100x60x85cm.

[SE901.01.04](#)

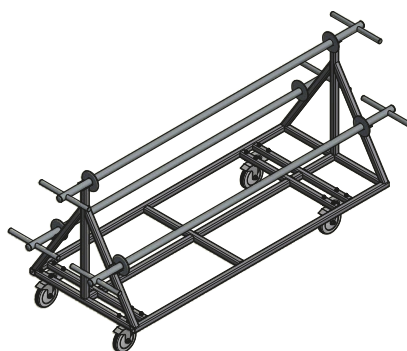

#### Storage trolley for 3 rolls of floor protection covering.

Trolley made of steel profiles, protect against corrosion by powder-coating. Equipped with rubber wheels [two with brake] and 3 steel, portable rods [zinc-galvanized] with handles. Designed for transporting and storing floor protection in rolls with width up to 2 m.

Max capacity: 400 kg.

[SE901.01.05](#)

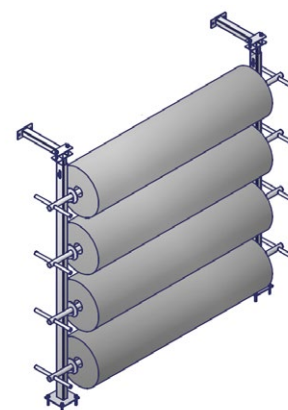

#### Storage unit for 4 rolls of floor protection covering or portable sports flooring.

Made of steel profiles, protect against corrosion by powder-coating. Equipped with portable rods [zinc-galvanized] with handles. Designed for storing on any rolls with width up to 2 m.

Manual winch available [upon request].

[SE902.04](#)

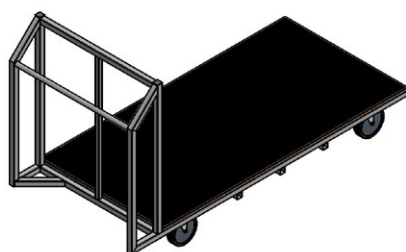

#### Transport and storage trolley for 100 floor protecting mats 2x1 m.

Made of steel profiles, protect against corrosion by powder-coating. Equipped with rubber wheels [two with brake]. Platform made of anti-slip and waterproof black plywood.

Max capacity: 800 kg.

[SE901.01.07](#)



#### Metal lockers

Functional, capacious and solid metal lockers used to arrange and collect minor sports equipment and various sports accessories (rackets, balls, jump ropes, lines, scarves, gym mats, gym equipment, etc.). Several types and dimensions available.

Made of steel, protect against corrosion by powder-coating [standard color RAL 7035 – grey].

[SE902.05](#)



# OUTDOOR EQUIPMENT







## NEW - OUTDOOR BASKETBALL 2,2 m

- Super durable - 5 years warranty for steel, hot galvanized components
- Tested by several international institution in reference to EN 1270
- Available with professional, UV resistant, 180x105 cm acrylic backboard
- Thanks to unique construction of backboard's frame, the acrylic glass has no holes, and the used gaskets prevents it from damages, even during heavy dunks
- In standard offered with superb durable basketball dunk ring, made in accordance to EN 1270 \*see below
- Safety pad for bottom edge of backboard included (installed on screws, made of polyurethane)

Outdoor basketball unit with projection of 2,2 m. Heavy-duty steel profile 150x150x4 mm, protected against corrosion by hot galvanization. Backboard installed to the frame with use of steel, powder coated [twice: base + final layer] L-shaped profiles in white. Backboard has no direct contact to the metal parts in order to prevent its damages [i.e. during dunking]. Provided with:

- 500 mm deep steel, hot galvanized socket
- acrylic backboard 180x105 cm on a steel frame
- professional dunk ring
- bottom edge safety pad

Optional features:

- Upright injury protecting pad – made of polyethylene foam, covered with UV and water resistant PVC. Height 200 cm, thickness 5 cm. Installed with use of Velcro.
- Height regulation mechanism 260-305 cm, provided with crank

**BB101.06**



# interplastic

INTERPLASTIC Roger Żółtowski  
Tuchom, ul. Gdyńska 45  
80-209 Chwaszczyno  
Poland

T +48 58 511 29 60  
F +48 58 511 29 80  
E [info@interplastic.pl](mailto:info@interplastic.pl)  
W [www.interplastic.pl](http://www.interplastic.pl)

