

SPRING GUIDE FEET, JOUSIOHJAIN JALAT

Attachments

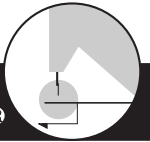

PIEDS AVEC RESSORT GUIDE
PIES PRENSATELA CON GUÍA

KANTENFEDER-FÜSSE
弓片式缝边压脚

SUISEI®

SG10~SG80

Spring Guide Hinged Feet
NIVELJOUSIOHJAIN JALKA

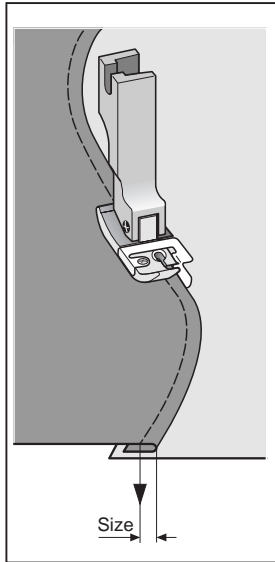

• For straight and curving edges.

SG10 1.0mm **SG15** 1.5mm **SG20** 2.0mm **SG30** 3.0mm

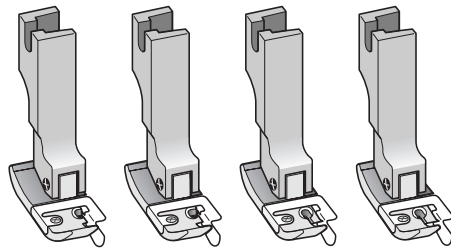

SG50 5.0mm **SG65** 6.5mm **SG80** 8.0mm

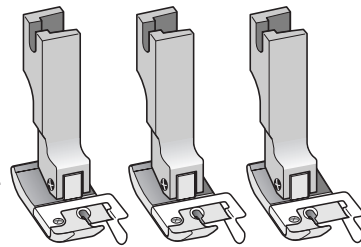

SG10L 1.0mm **SG15L** 1.5mm **SG20L** 2.0mm **SG30L** 3.0mm

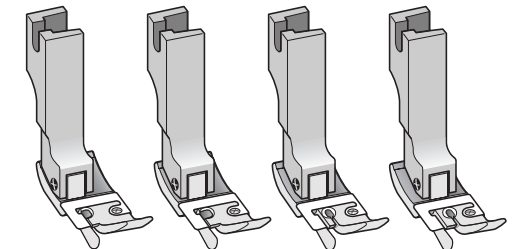

Screw & Spring Guides		Hinged Raising Feet	Spring Guide Feet
SG-P0 For all Feet	M1.6x0.35	P810 →	SG10
SG-P1 For SG10~SG30		P811 →	SG15
SG-P2 For SG50~SG80		P812 →	SG30
SG-P1L For SG10L~SG30L		P813 →	SG50
		P814 →	SG65
		P815 →	SG80
		P810L →	SG10L
		P811L →	SG15L
		P812L →	SG30L

• Hinged raising feet <Right> "P810~P818" are discontinued.
We do recommend them instead of "P810~P815".

P10~P18

Top Stitch Guide Feet
JOUSIOHJAIN PAININJALKA

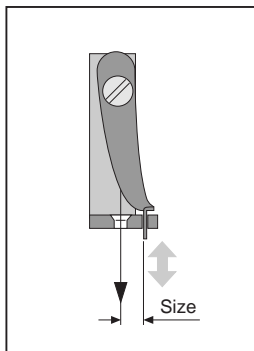

P10 0.8mm 1/32" **P11** 1.6mm 1/16" **P115** 2.4mm 3/32" **P12** 3.2mm 1/8" **P13** 4.8mm 3/16"

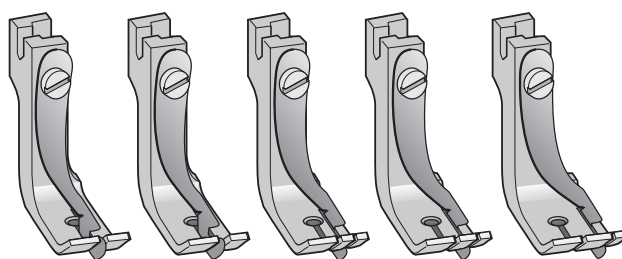

P14 6.4mm 1/4" **P15** 8.0mm 5/16" **P16** 9.5mm 3/8" **P18** 12.7mm 1/2"

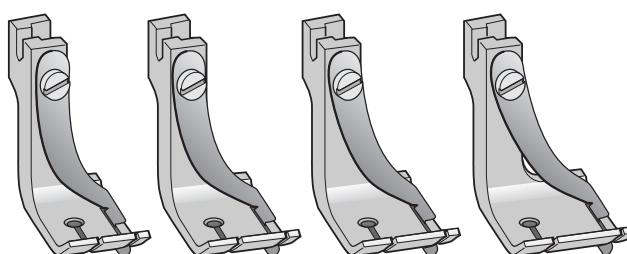

Screw & Spring Guides	
3352 For all Feet	3/32-56
P01 For P10~P13	
P01W For P14~P18	

• The lower material can be hurt by the spring guide when it is weak and thin. Then compensating feet are recommended.